

## FLANGE

# Carbon Steel Forged Flange

REF **EFC-248** ISSUED 05 Jun 2026

## SPECIFICATIONS

Size	<b>DN50–DN600</b>
Pressure	<b>PN10 / 150LB–PN40 / 300LB</b>
End connection	<b>flanged (ANSI B16.5) / flanged (ANSI B16.5) / flanged (GB/T9119-2000) / flanged (GB/T9119-2000) / flanged (DIN/BS/JIS)</b>
Media	<b>oil and gas, petrochemical media, water</b>

## STANDARDS

Design **ANSI B16.5, AWWA C207, GB/T9119-2000**

## APPROVALS & CERTIFICATIONS

- LR (Lloyd's Register) approved
- ECM (Ente Certificazione Macchine) certified
- ISO certified
- EAC (Eurasian Conformity) marked
- CE marked
- Bureau Veritas certified
- ACS (Attestation de Conformité Sanitaire) approved
- WRAS Approved Product

## APPLICATIONS

- Oil and gas pipelines
- Petrochemical plants
- Power plants
- Water infrastructure
- Above-ground installations
- Underground installations



## MATERIALS

body **Carbon Steel**

## FEATURES

- Forged construction providing high tensile strength
- Dimensional inspection performed on each unit
- Pressure testing performed on each unit
- Surface treatment applied
- Special design available on request
- Flat face / slip-on flange type (image 0)
- Weld neck flange type (image 1)
- Dimensional parameters: overall outer diameter ( $\varnothing D$ ), bolt circle diameter ( $\varnothing D1$ ), bolt hole diameter ( $\varnothing d$ ), bolt hole count ( $n$ ) — as labelled in sectional drawing

## OPTIONS & NOTES

- Special design available
- Material options include Carbon Steel, Alloy Steel and Stainless Steel

## PRESSURE-TEMPERATURE RATING

CLASS	TEMPERATURE	MAX PRESSURE
—	°C	1 MPa
—	°C	1.6 MPa

FLANGE

# Carbon Steel Forged Flange

SECTION Technical drawing REF EFC-248

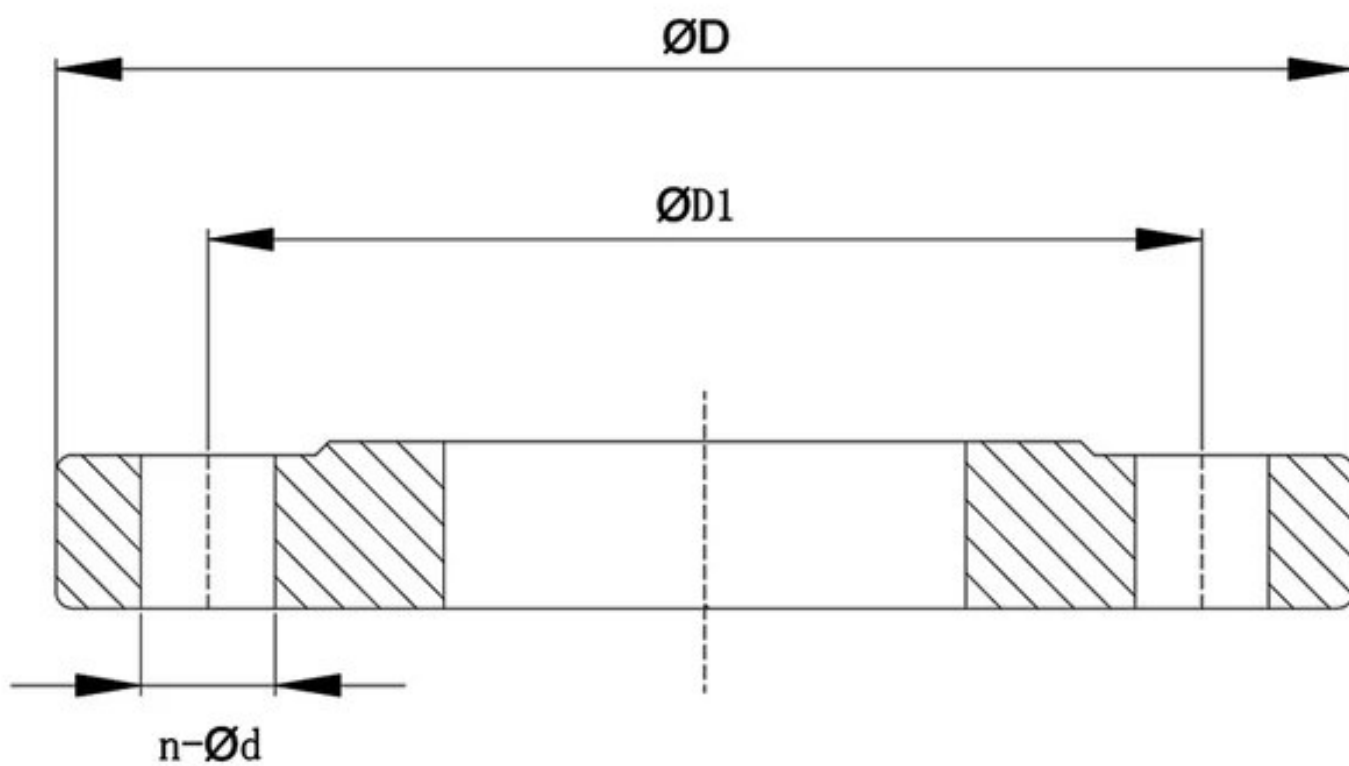

FLANGE

# Carbon Steel Forged Flange

SECTION Dimensions per size REF EFC-248

SIZE	D	D1	NXD
DN50	165	125	4X18
DN65	185	145	8X18
DN80	200	160	8X18
DN100	220	180	8X18
DN125	250	210	8X18
DN150	285	240	8X22
DN200	340	295	12X26
DN250	405	355	12X26
DN300	460	410	16X26
DN350	520	470	16X26
DN400	580	525	16X30
DN450	640	585	20X30
DN500	715	650	20X30
DN600	840	770	20X36
DN50	165	125	4X18
DN65	185	145	8X18
DN80	200	160	8X18

## Carbon Steel Forged Flange

Dimensions per size (continued) · EFC-248

SIZE	D	D1	NXD
DN100	220	180	8X18
DN125	250	210	8X18
DN150	285	240	8X22
DN200	340	295	8X22
DN250	395	350	12X22
DN300	445	400	12X22
DN350	505	460	16X22
DN400	465	515	16X26
DN450	615	565	20X26
DN500	670	620	20X26
DN600	780	725	20X30

*All dimensions in millimetres unless stated otherwise. Values are nominal; tolerances confirmed at quote.*