

PLUG VALVE

Plug Valve (2 way)

REF **EFC-189** ISSUED 05 Jun 2026

SPECIFICATIONS

Size	DN50–DN200
Pressure	PN10–PN40
End connection	flanged (DIN EN 1092-1/2) / flanged (DIN EN 1092-1/2) / flanged (BS 4504)
Face-to-face	DIN EN 558-1/1

ACTUATION

- manual lever — wrench/lever operated

STANDARDS

Design	BS 1735
--------	----------------



MATERIALS

body	grey cast iron, ductile iron, cast steel	gasket	elastomer, compressed fibre
bonnet	grey cast iron, ductile iron, cast steel	packing	polymer

PLUG VALVE

Plug Valve (2 way)

SECTION Technical drawing REF EFC-189

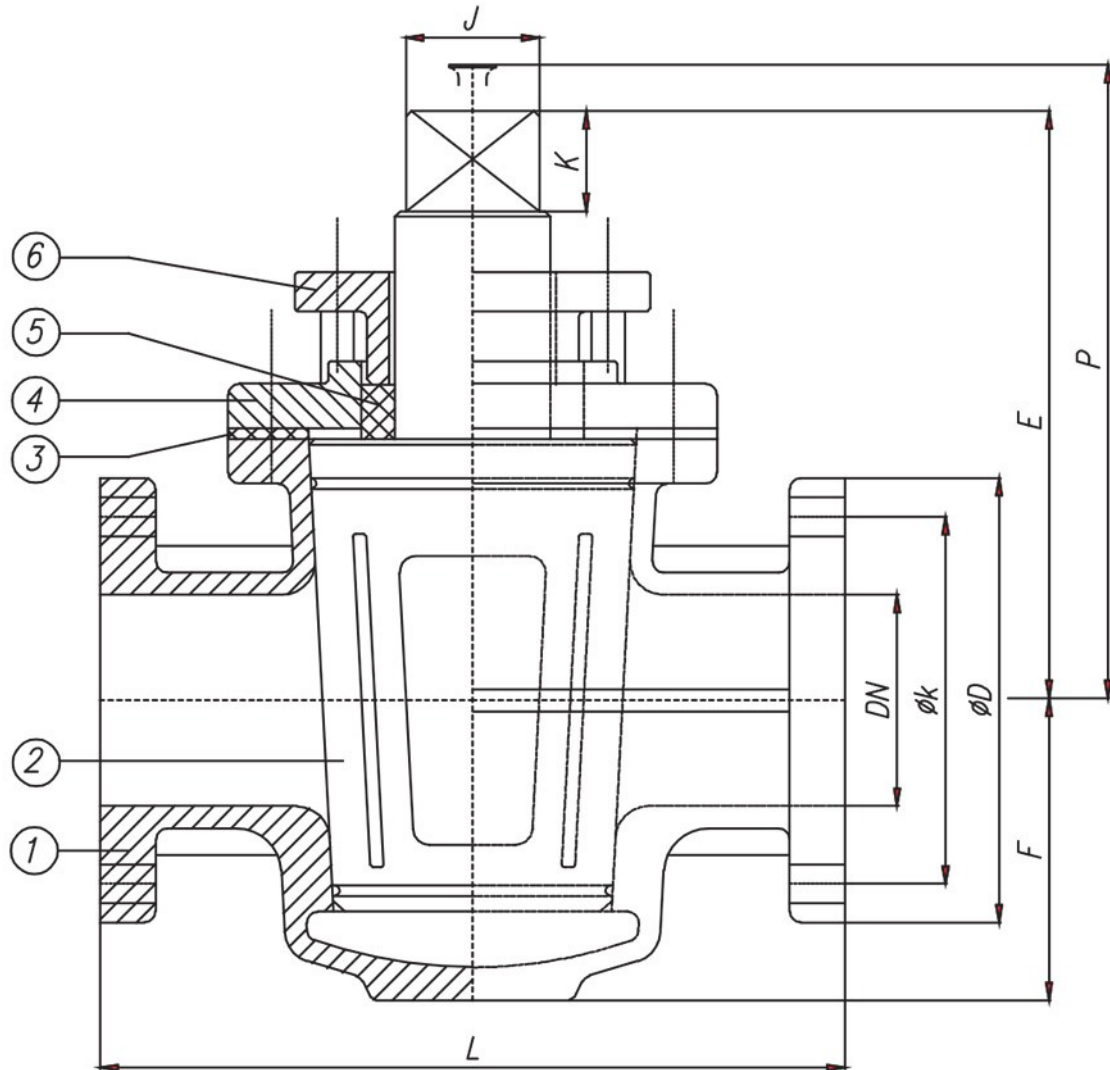

PLUG VALVE

Plug Valve (2 way)

SECTION Dimensions per size REF EFC-189

SIZE	L	E	F	P	J	K	WEIGHT
DN50	230	160	70	225	27	27	15 kg
DN65	290	173	85	254	32	32	20 kg
DN80	310	211	100	292	37	38	28 kg
DN100	350	230	114	350	41	46	32 kg
DN125	400	265	124	365	41	46	60 kg
DN150	480	292	162	422	54	60	87 kg
DN200	600	327	192	457	54	60	105 kg

All dimensions in millimetres unless stated otherwise. Values are nominal; tolerances confirmed at quote.