

STORM VALVE

Angle Form Storm Valve

MODEL VFVA-10 REF EFC-152 ISSUED 05 Jun 2026

SPECIFICATIONS

Size	DN50–DN350
Pressure	PN10
End connection	flanged (DIN-HNA PN4) / flanged (DN 2532)
Face-to-face	DIN-HNA PN4, DN 2532
Media	water, stormwater

ACTUATION

- manual spindle — With Spindle (Kumanda Mili)

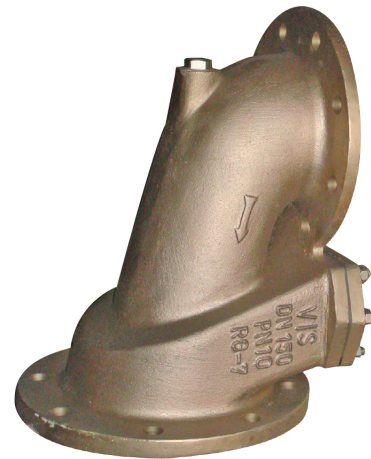
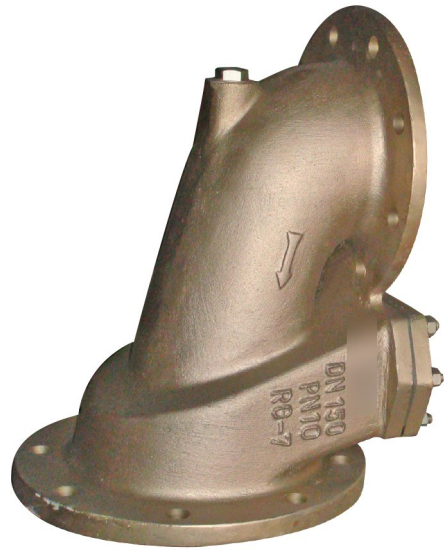

MATERIALS

body	ductile iron, cast steel, bronze, copper alloy, stainless steel, duplex stainless steel	bonnet	ductile iron, cast steel, bronze, copper alloy, stainless steel, duplex stainless steel
disc	bronze, copper alloy, stainless steel, duplex stainless steel	gasket	elastomer

FEATURES

- Angle form (kø_e tip) body configuration
- Spindle-operated flap disc
- Optional position indicator
- Available with ANSI and JIS flange options
- Multiple body material options including bronze, ductile iron, cast steel, stainless steel, and duplex stainless steel

STORM VALVE

Angle Form Storm Valve

SECTION Technical drawing REF EFC-152

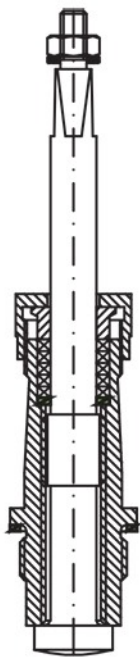

KUMANDA MILI
With Spindle

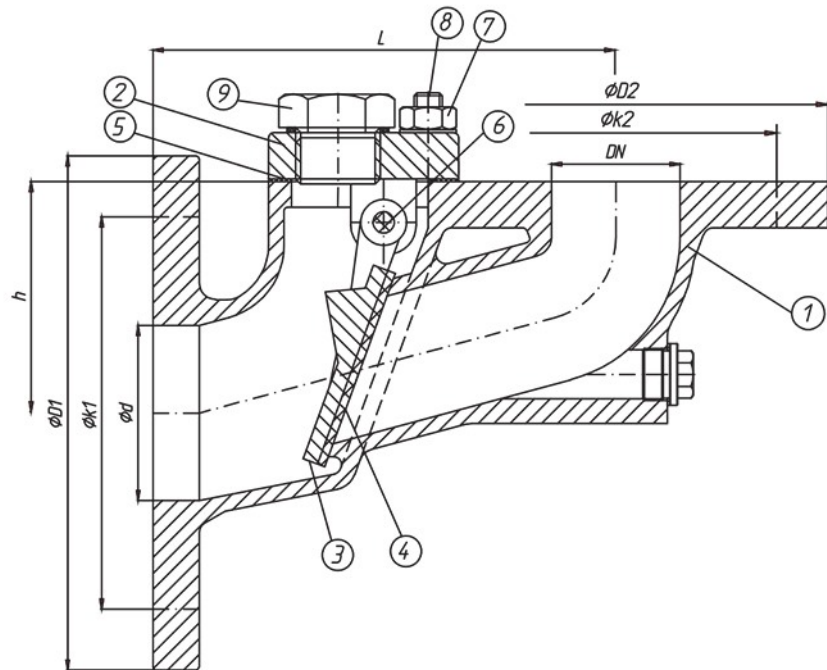

STORM VALVE

Angle Form Storm Valve

SECTION Dimensions per size REF EFC-152

SIZE	OD	OD1	OK1	OD2	OK2	L	H	WEIGHT
DN50	80	200	160	165	125	180	90	12 kg
DN65	100	220	180	185	145	200	100	14 kg
DN80	125	250	210	200	160	215	108	18 kg
DN100	150	285	240	220	180	250	130	25 kg
DN125	175	315	270	250	210	290	152	35 kg
DN150	200	340	295	285	240	330	176	43 kg
DN200	250	395	350	285	295	425	200	72 kg
DN250	305	445	400	285	350	630	370	150 kg
DN300	400	565	515	285	400	650	370	250 kg
DN350	400	565	515	285	460	800	460	325 kg

All dimensions in millimetres unless stated otherwise. Values are nominal; tolerances confirmed at quote.